

Power Zone® Adjustable Self-facing Merchandiser

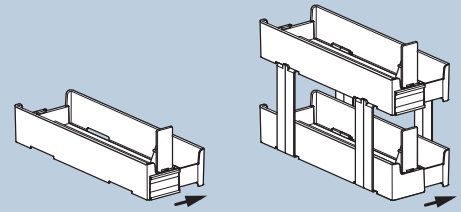

4162843710

4162843720

Features and Benefits

- ◆ Integrated pusher system enables hands-free facing with automatically advanced product
- ◆ Provides inventory control and easily identifiable out-of-stocks
- ◆ Adjusts from 2.5" W to 3.75" W (I.D.) to accommodate various product widths
- ◆ Attaches to perforated shelves with two Viking Clips (included)
- ◆ Available in single-tier or double-tier design
- ◆ Double-tier style is ideal for displaying short, hard-to-stack product beside taller product (bottom shelf accommodates product up to 3.5" H)
- ◆ Top tier of double-tier merchandiser contains a 2" W c-channel for signage
- ◆ Pre-assembled for easy installation
- ◆ 12" variable force pusher track with stainless steel springs and natural paddle
- ◆ Clear high impact polycarbonate

Pre-assembled portable self-facing merchandiser

The Power Zone® Adjustable Self-facing Merchandiser offers a convenient, portable solution for merchandising products in various categories throughout the store. The integrated pusher system enables hands-free facing with automatically advanced product while providing inventory control and easily identifiable out-of-stocks.

The clear design ensures product is 100% visible and accessible, and complements any shelf color and store décor. The Double-Tier Merchandiser is the perfect solution for displaying short, hard to stack product beside taller product.

Specifications

Item No.	Ref. No.	Style	Dimensions	Pack
4162843710	-	Single Tier	3.25" H x 12" D	1
4162843720	-	Double Tier	8.25" H x 12" D	1

Call for details. Minimum quantities may apply.

20190313

For more information,
call **800.422.2547**
or visit www.siffron.com

siffron™
always on